

Moscow-City Transportation Terminal, Moscow, Russia



Client
Citer Invest BV

Value
USD 408million

Area
240 000 m²

Duration
2006 – 2009

Assignment
Project & Construction Manager/Zakazchik

Architect
NBBJ

Services/Structural Engineers
Ove Arup & Partners.

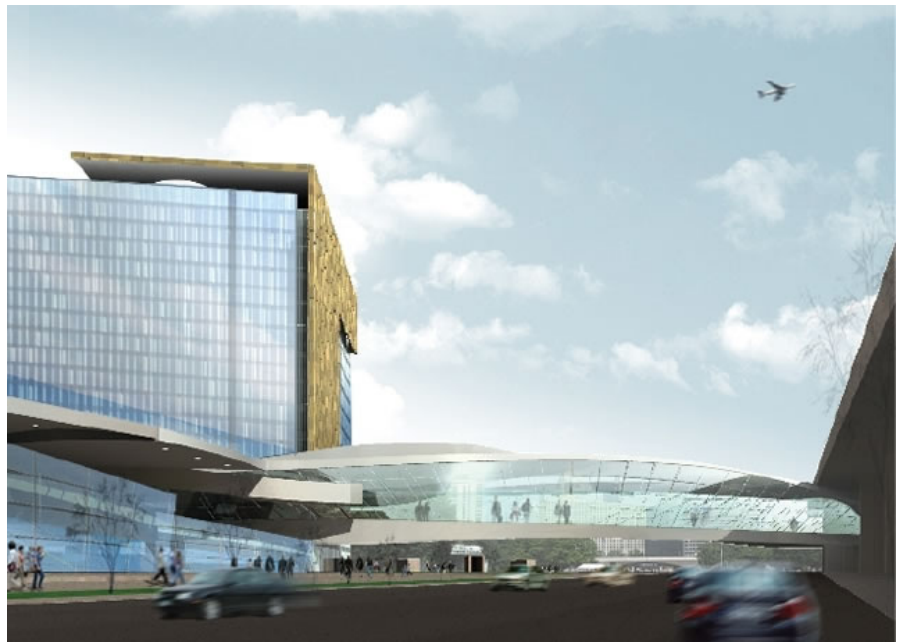

At present Bovis Lend Lease (BLL) provides construction management of the Transport Terminal on Plot 11 of the MIBC Moscow City Transportation Terminal Project.

Transportation Terminal is a connection point for transport routes required for the Moscow City business centre and the following transport facilities:

- High-speed transport system (high-speed railway)
- Third transport ring (vehicle flows)
- Mini-metro
- Bus traffic
- Vehicular traffic

In view of the Terminal proximity to the third transport ring much attention is paid to roads ensuring vehicular circulation and to parking areas. There is a connection with the Central Core and the high-speed railway (HSR) through a bridge and a direct access to office and hotel areas located on upper levels.

Transportation Terminal complex includes two office buildings (Office Tower 1 and Office Tower 2) linked at the terminal level and by aerial links, a connection with the HSR station located under the third transport ring, an international 4 star hotel, an underground car park and plant rooms. The three towers and the terminal building rest on the common underground base. Gross area of Plot 11 is 1,137 ha with the overall construction area of the complex totaling 240,422 m² (circa) including 86,416 m² substructure and 154,006 m² superstructure.

Scope of BLL services includes project management and construction management including the Zakazchik role.

The project will be delivered in a single phase.